

**B. Tech. Project Presentation**

# **Supply Chain Solutions for SARAS DAIRY**

## **Mentors**

- Dr. Gaurav Ameta
- Dr. Milind Sharma

## **Team Members**

- Aditya Khandelwal
- Ajay Jagetiya
- Saurabh Pandey
- Vaibhav Gupta

[TheCaseSolution.Com](http://TheCaseSolution.Com)



Thank You

**A Dairy's Diary**  
Project Description

**Quality Management System:** Suggesting implementation of Industrial Engineering Techniques and Good Manufacturing Practices.

**Forecasting:** Forecasting model to accurately determine supply and sales of dairy

**Vehicle Routing:** Optimising distribution network across Jodhpur

**The SARAS Stimulus**

**Motivation**

- Bridge the gap between marketing research and industries (IMRI)
- Setting an IT Responsibility to serve the society

**Why SARAS ?**

- Established in 1973
- Old Technology and Methodology
- G.M. Organisation. All advantages freely result to farmers.

**B. Tech. Project Presentation**

**Supply Chain Solutions for SARAS DAIRY**

<b>Mentors</b>	<b>Team Members</b>
- Dr. Gaurav Ameta	- Aditya Khandelwal    - Saurabh Pandey
- Dr. Milind Sharma	- Ajay Jagetiya        - Vaibhav Gupta

[TheCaseSolution.Com](http://TheCaseSolution.Com)

# A Dairy's Diary

## Project Description

Quality Management System:

Suggesting implementation of Industrial Engineering Techniques and Good Manufacturing Practices

Forecasting:

Forecasting model to accurately determine supply and sales of dairy

Vehicle Routing:

Optimising distribution network across Jodhpur

# The SARAS Stimulus

## Motivation

- Bridge the gap between ongoing research and Industries (SMEs)
- Being an IIT : Responsibility to serve the society

## Why SARAS ?

- Established in 1972
- Old Technology and Methodology
- Govt. Organization: All advantages directly reach to farmers

# System Specifications

## Understanding the Plant

### Plant Layout



### Supply Chain



### Information

#### Other Details

- Milk Products: Milk - Full Cream ; Toned ; Double Toned ; Standard ; Skimmed
- Other Products - Namkeen Chhach ; Chhach ; Lassi ; Paneer ; Ghee ; Dahi ; Shrikhand
- Processing Capacity per day:100000 ltr per day
- Certification - ISO 9001:2000  
ISO 15000 (HACCP)

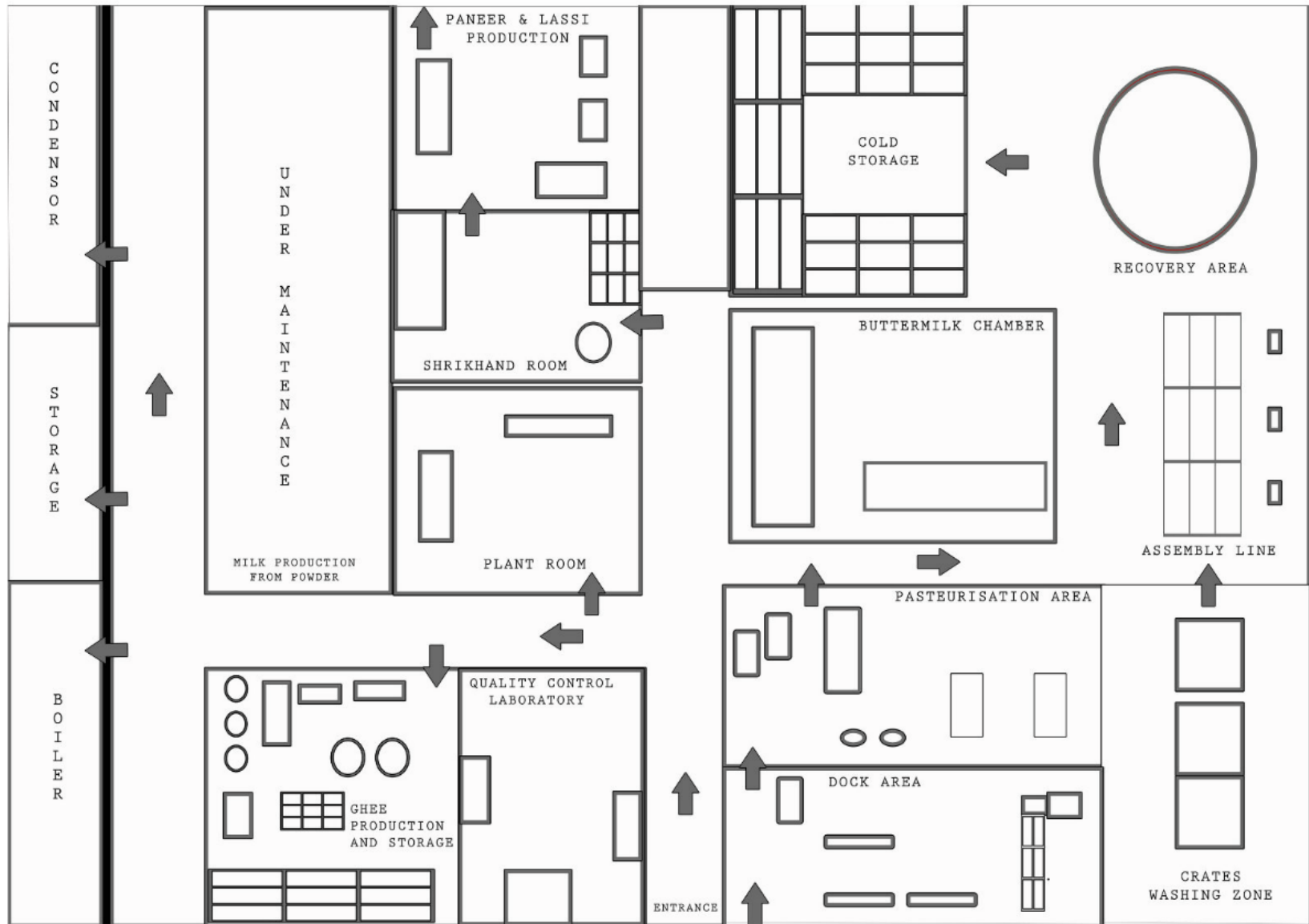

SARAS DAIRY PLANT LAYOUT

